



P Mount Industrial Foot

Description

The product consists of the base foot and a spherical head bolt. The base foot is made of a vulcanised rubber or 70 shore hardness. Moulded into the base is a steel core with a spherical aperture to accept the ball at the head of the bolt. The unit will allow a 20° deviation from vertical. A half nut is supplied to lock the stud into position after installation.



Application

Food industry machines, packaging machines, conveyors, benches, shelves, containers, heating units, chillers, generator sets, motor.
Provides fast easy levelling with an element of vibration damping.



Material Specification

Nut and Bolt	Mild Steel with Zin Plate Stainless Steel available on request.
Base Pad	70 Durometer Nitrile Rubber

Variation Options

Base foot without anchorage holes	Standard
Base foot with anchorage holes	On request

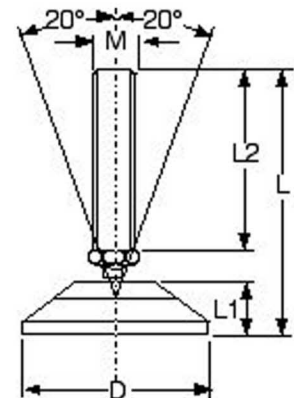

P Mount Industrial Foot



		'P' Mount Industrial Foot						Mild Steel		Stainless		
Part Number Example		Type	D	L1	M	L2	L	Load (kg)	No Hole Base	Hole in Base	No Hole Base	Hole in Base
<u>P 75/M16-90/U</u>												
P75 - Base Diameter		P 30	30	15	8	30	57	250	+		+	
M16 - Thread Size			30	15	8	80	107	250	+		+	
90 - Length of Bolt Thread		P50	50	22	10	80	114	500	+		+	
U - With Hold Down Holes			50	22	10	130	164	500	+			
			50	22	12	90	124	600	+		+	
			50	22	12	130	164	600	+		+	
			50	22	16	90	127	800	+		+	
			50	22	16	150	187	800	+			
			50	22	16	180	217	800	+			
		P75	75	26	10	80	118	600	+	+	+	+
			75	26	10	130	168	600	+	+		+
			75	26	12	90	128	700	+	+	+	+
			75	26	12	130	168	700	+	+	+	+
			75	26	16	40	81	900				
			75	26	16	60	101	900	+			
			75	26	16	90	131	900	+	+	+	+
			75	26	16	120	161	900	+			+
			75	26	16	150	191	900	+	+		+
			75	26	16	180	221	900	+	+		+
		P100	100	30	16	90	135	1000	+	+	+	+
			100	30	16	150	195	1000	+	+		+
			100	30	16	180	225	1000	+	+		+
			100	30	20	100	149	1200	+	+	+	+
			100	30	20	150	199	1200	+	+	+	+
			100	30	24	120	175	2200	+			
			100	30	24	160	215	2200	+	+	+	+
		P130	130	36	20	150	204	1500		+		+
			130	36	24	160	221	2800		+		+
			130	36	27	160	221	3000		+		+
			130	36	30	160	221	3200		+		+
		P150	150	44	20	100	162	1500	+			
			150	44	20	150	212	1500	+		+	
			150	44	24	160	229	2800	+		+	
			150	44	27	160	229	3000	+		+	
			150	44	30	120	189	3200	+			
			150	44	30	##	229	##	+		+	

